

## Design Features:

- 2 Way Ball Valve 3", Full Port
- Max PSI 100
- NEMA 6P Actuator housing
- Ball: Polypropylene
- Stem: 316 SS
- Valve Body: Polypropylene
- Seat: Virgin PTFE
- Stem O-Ring: VITON



Cycle Time and Voltage			
MOTOR	12 VDC	24 VDC	24 VAC
U	8 sec	4 sec	4 sec
V	n/a	.75 sec	.75 sec
W	3 sec	1.5 sec	1.5 sec
Y	1.5 sec	n/a	n/a

## HOW TO ORDER BY PART NUMBER

### 99K - 60A - W -

VALVE SERIES	VALVE SIZE	WIRING OPTION	MOTOR	OPTION
99 - 2-WAY POLYPROPYLENE BALL VALVE	K - 3"	60A - 3 wire on/off (+) SPST 12 VDC 60T - 3 wire on/off (-) SPST 12VDC 63 - 4 wire 3 position 12VDC 60 - 4 wire on/off with feedback 66 - 3 wire on/off SPST 24VAC 55 - 4 wire on/off SPST 12VDC 50K - 2 wire DPDT 41 - 2 wire DPDT with 5k Pot. 62 - 4 wire regulating 12VDC 41S - DPDT with pot. for SL Control 60AE - SPST with 2 dry switches 50KE - DPDT with 2 dry switches 60F - SPST with two 12V outputs  Other options available, consult factory	U - 8 SEC W - 3 SEC Y - 1.5 SEC  All @ 13.8 VDC  V - .75 SEC*  *24V Only	- BLANK FOR NO OPTION 4 - EH4 B - BLANK LID (NO DOME) ON MOTOR CASE C - "NC" NORMALLY CLOSED H - "LESS VALVE" KIT O - "NO" NORMALLY OPEN V - 180 DEGREE OPERATION

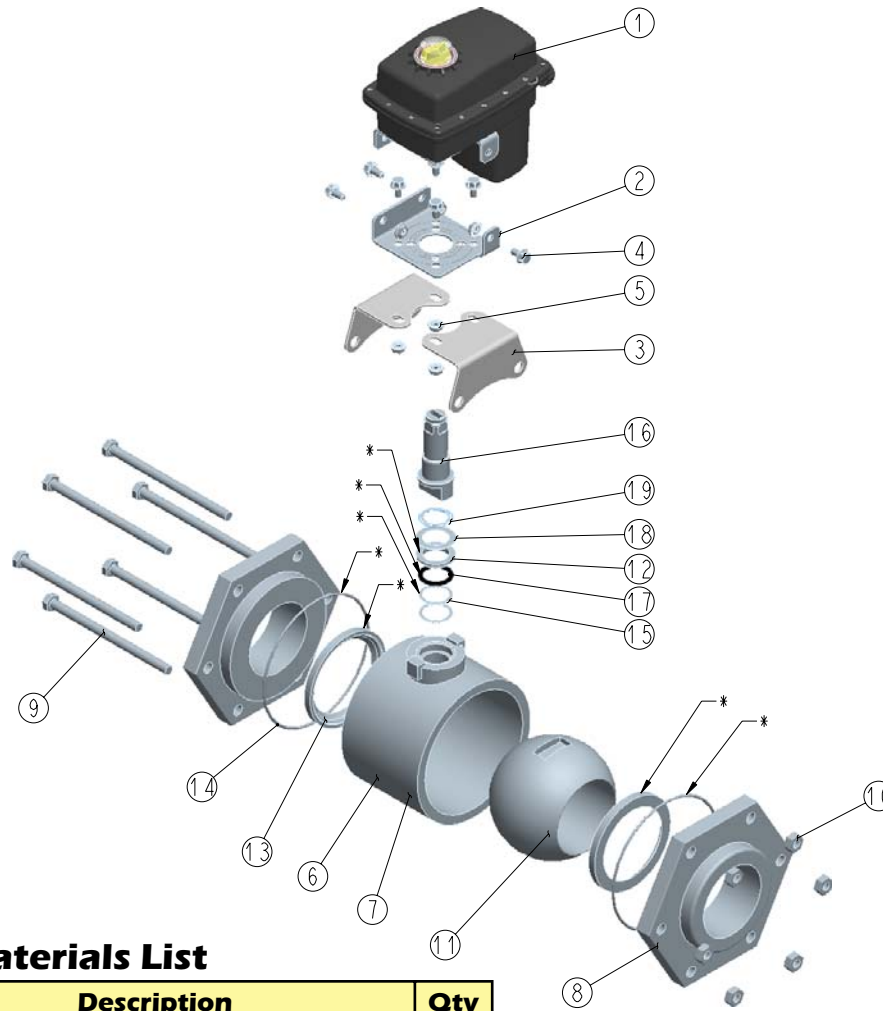

## Materials List

No.	P/N	Description	Qty
1		EH2 Actuator	1
2	100437	Bracket, ISO FO4, FO5, FO7, SS	1
3	100210	Bracket, SS	2
4	100204	Bolt, Serrated Flange Hex, .250-20 UNC - 2A x .5, SS	7
5	OX-222	Nut, Serrated Flange Hex, .250-20 UNC-2B, SS	7
6	EH2-1180	Valve Assembly, 3", POLYPROPYLENE	1
7		Valve Body, POLYPROPYLENE	1
8		End Cap, 3" FNPT, POLY PROPYLENE	2
9		Bolt, SS	6
10		Nut, SS	6
11		Ball, POLYPROPYLENE	1
12		Stem Packing,	1
13		Seat,	2
14		O-ring,	2
15		Thrust Washer,	2
16	100212	Stem, SS	1
17	EHPT-177	O-ring	1
18	102-0009	Washer, SS	1
19	EHPT-170	Retainer Ring, SS	1
*	EH2-1181	Repair Kit	1

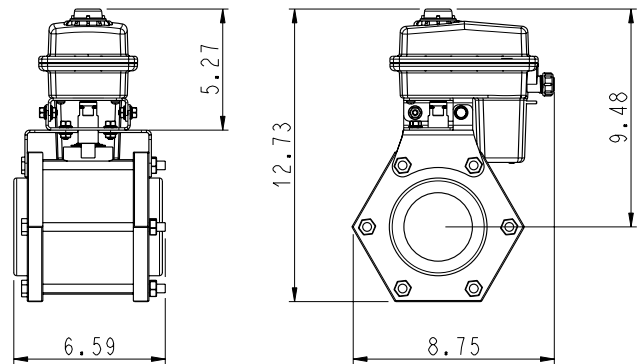

Actuator	Weight (LBS)
EH2	10.9

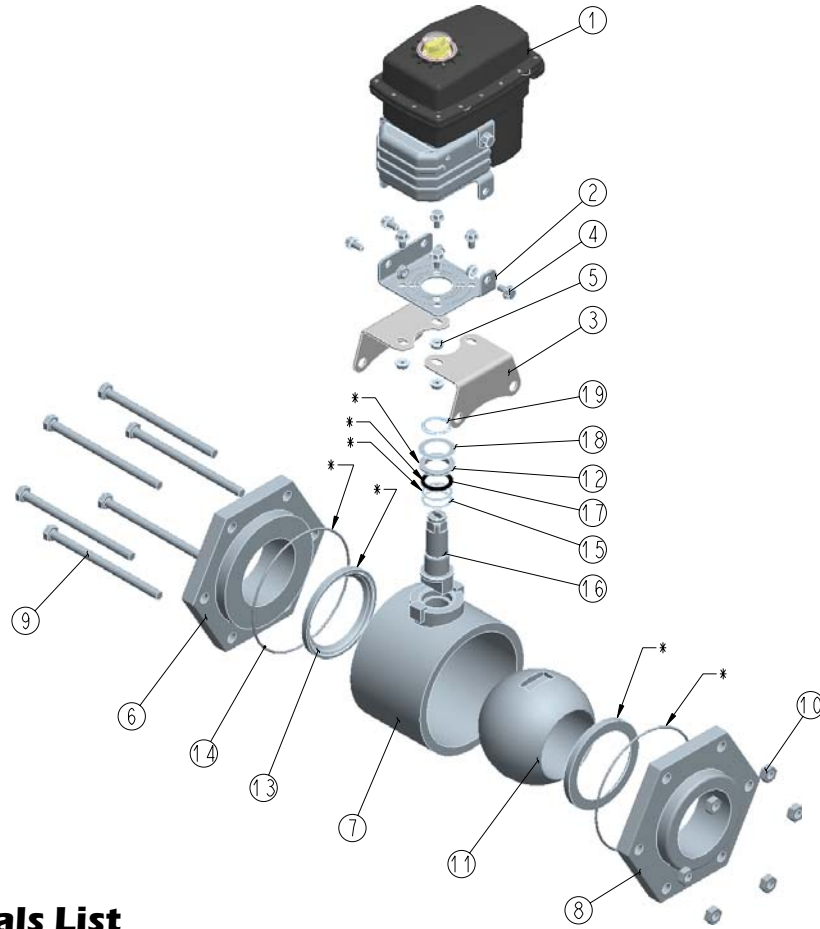

## Materials List

No.	P/N	Description	Qty
1		EH4 Actuator	1
2	100437	Bracket, ISO FO4, FO5, FO7, SS	1
3	100210	Bracket, SS	2
4	100204	Bolt, Serrated Flange Hex, .250-20 UNC - 2A, SS	7
5	OX-222	Nut, Serrated Flange Hex, .250-20 UNC-2B, SS	7
6	EH2-1180	Valve Assembly, 3", POLYPROPYLENE	1
7		Valve Body, POLYPROPYLENE	1
8		End Cap, 3" FNPT, POLYPROPYLENE	2
9		Bolt, SS	6
10		Nut, SS	6
11		Ball, POLYPROPYLENE	1
12		Stem Packing,	1
13		Seat,	2
14		O-ring,	2
15		Thrust Washer,	2
16	100212	Stem, SS	1
17	EHPT-177	O-ring	1
18	102-0009	Washer, SS	1
19	EHPT-170	Retainer Ring, SS	1
*	EH2-1181	Repair Kit	1

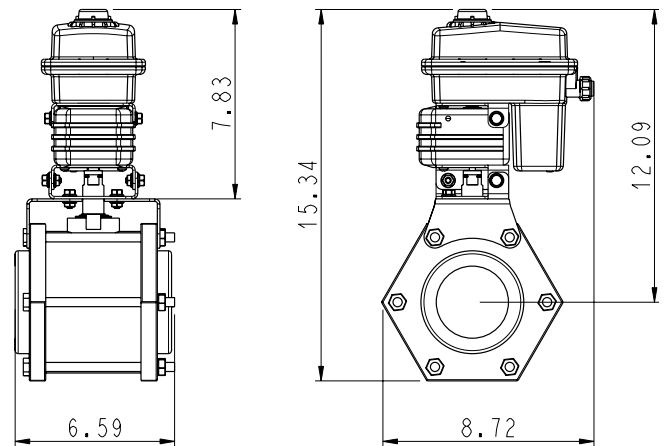

Actuator	Weight (LBS)
EH4	15.2